

FRP COMPOSITE DOOR



Advantages of Composite Door

- Both side smooth surface
- Flame retardant property
- Water-proof
- Non Corrosive
- Strength and durability
- No risk of theft
- Dielectric
- Maintenance free



Composito Door Model

- * Single Half Louver Door : TNB 1HL
- * Double Half Louver Door : TNB 2HLL
- * Single Full Louver Door : TNB 1FL
- * Double Full Louver Door : TNB 2FL
- * Single Solid Door : TNB 1SD
- * Double Solid Door : TNB 2SD
- * Louver Window : TNB LW

Advantages of Composite Door

- Both side smooth surface
- Flame retardant property
- Water-proof
- Non Corrosive
- Strength and durability
- No risk of theft
- Dielectric
- Mitintenance free



HEALTHCARE X-RAY DOOR



This product a range of seamless x-ray doors that are ideally suited to hospitals and other sterile environments where hygiene and x-ray Protection are of utmost importance. Lead-line door sets incorporate lead sheeting in a range of thicknesses. This protection extends through the door frames, forming an effective barrier to radiation in all directions.

EST. 1999

ASIAHAI

ASIA · 亞洲 · اسيا

اسياهاي ايندستري

ASIAHAI INDUSTRIES SDN. BHD.

No.11, Jalan Wira 5,
Taman Tan Sri Yaacob Industrial Park,
81300 Skudai, Johor Bahru, Johor,
West Malaysia.

523959-W

- ✉ : enquiry@asiahai.com.my
- 🌐 : www.asiahai.com.my
- 📍 : Asiahai Industres Sdn Bhd - Door Supplier

DISTRIBUTORS:

The product picture is only for reference.
Please refer the actual object as the standard.

SPECIALTY DOORS



FIRE RESISTANCE STEEL DOOR



Metech Insulated Fire Steel Doors

Designed to Malaysia Standard fire doors. It has the advantage of reliability in quality and low in maintenance after installation. It does not warp over time and all materials are recyclable which contribute towards green buildings index.

Fire Resistant

Approved 1 and 2 hours by Bomba Malaysia MS 1073: PART 3 : 1996

Door Frame

Fabricated from first grade galvanised steel of 1.5mmn thickness. Reinforced backplated and protection cover for hinges, door closers and locksets striker plates. Cap with ceramic loard for maximum insulation purpose.

Door Panel

Fabricated from first grade galvanised steel of 1.2mmnn thickness with insulated core. Reinforced plates for hinges, door closers and lockset are provided as standard intumescent seal areinstalled for extra safety.

Vision Panel

Constructed with first grade galvanised steel frame capping and fixed with 5.0mm compartment lite fire rated glass. The gaps between the glass and capping stiffener is lined with a layer of ceramic board. Standard size : Width 150mm x Height 300mm

Finishing

One coat of anti rust primer as standard finishing.

Specifications

2 Hours

- Made of Electro-galvanized steel
- Standard Frame (depth - 150mm)
- Standard Panel (face sheet thickness from 1.2mm)
- Standard Panel (thickness - 50mm)
- Hard wares tested for fire resistant (SIRIM and BOMBA approved)

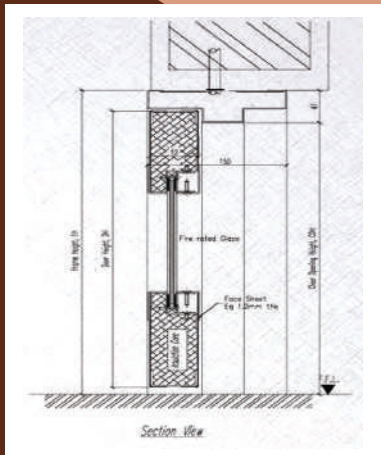
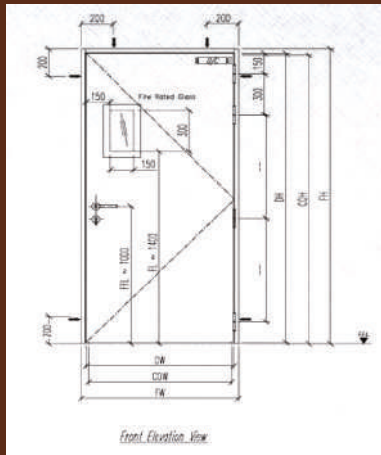
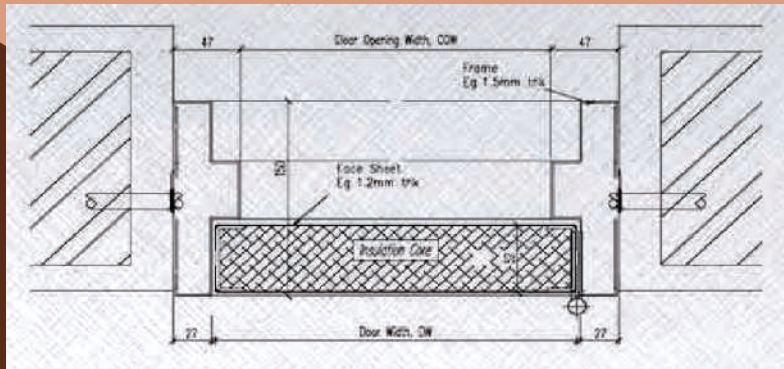

FIRE RATED DOOR



Double Leaf

Single Leaf

CERTIFICATE



SINGLE LEAF

PROFIT Fire Door Set meets the requirements of the ms 1073 Part 3 1996 (Amd 1:2003) after the completion of 50,000 cycles.

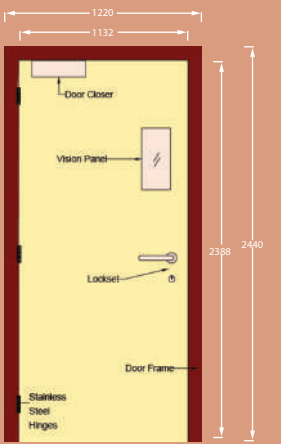

Door Frame Size - One Hour Single Leaf (maximum size 1220mm x 2440mm)

DOUBLE LEAF

PROFIT Fire Door Set meets the requirements of f the MS 1073: Part 3: 1996 (Amd. 1:2003) after the completion of 50,000 cycles:
• The Door Set was capable of closing properly, maintaining all clearance between leaf to frame and floor.
• No visible signs of undue wear or damage on any part of the assembly or other defects that could impair its reliability of functioning.

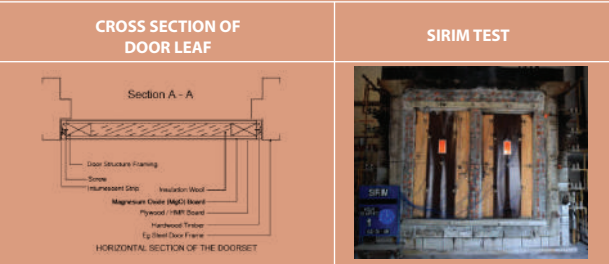

Door Frame Size - One Hour Double Leaf (maximum size 2440mm x 2440mm)

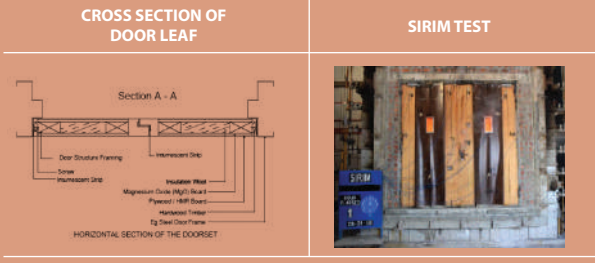

SINGLE LEAF

PROFIT Fire Door Set meets the requirements of the ms 1073 Part 3 1996 (Amd 1:2003) after the completion of 100,000 cycles.

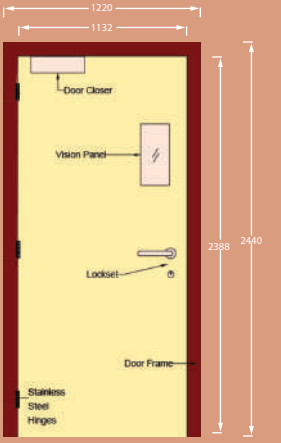

Door Frame Size - One Hour Single Leaf (maximum size 1220mm x 2440mm)

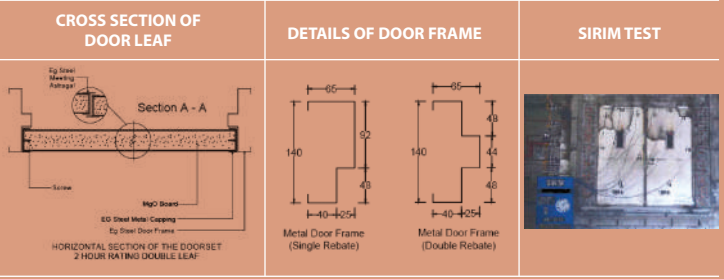
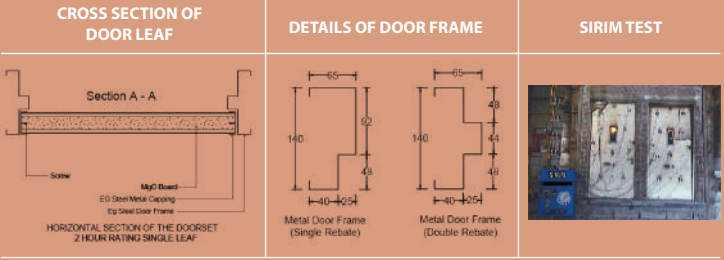

DOUBLE LEAF

PROFIT Fire Door Set meets the requirements o f the MS 1073: Part 3: 1996 (Amd. 1:2003) after the completion of 50,000 cycles:
• The Door Set was capable of closing properly, maintaining all clearance between leaf to frame and floor.
• No visible signs of undue wear or damage on any part of the assembly or other defects that could impair its reliability of functioning.

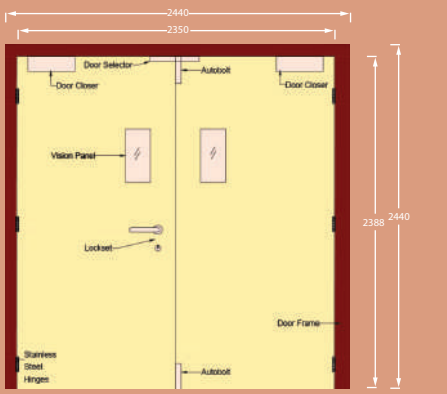

Door Frame Size - Two Hour Double Leaf (maximum size 2440mm x 2440mm)

ACCESSORIES

